



PREMIUM

GREAVES

VERTICAL WORM GEARBOXES



Authorised Distributors

SC Industrial Syndicate

5/105, Bombay Samachar Marg, Fort, Mumbai 400 023

Tel : 022 2266 3444 / 5615 / 5439 / 1840 / 1079 Fax : 2266 0628

Website : www.scindustrial.com Email : sales@scindustrial.com

SC Industrial Syndicate



PREMIUM

Ratings at 1500 RPM Input Speed

Nominal Ratio RPM	Nominal Output	Capacity	Unit Size					
			112	162	200	237	287	337
5/1	300	Input Power KW	0.548	1.243	2.72	4.05	5.51	10.8
		Output Torque Nm	16.6	38.4	77.5	121	171	312
7.5/1	200	Input Power KW	-	1.081	1.93	2.92	4.76	7.24
		Output Torque Nm	-	45.8	82.6	126	203	311
10/1	150	Input Power KW	0.432	1.052	1.88	2.60	3.82	6.29
		Output Torque Nm	24.6	61.8	112	146	228	354
15/1	100	Input Power KW	0.329	0.942	1.50	2.30	3.71	5.62
		Output Torque Nm	25.0	73.5	120	186	301	462
20/1	75	Input Power KW	0.300	0.655	1.40	2.30	3.71	5.62
		Output Torque Nm	28.3	67.1	142	233	294	447
25/1	60	Input Power KW	0.266	0.578	1.14	1.83	2.74	3.91
		Output Torque Nm	30.2	70.8	142	231	352	511
30/1	50	Input Power KW	0.217	0.515	0.94	1.46	2.31	3.50
		Output Torque Nm	28.5	73.0	137	214	348	537
40/1	37.5	Input Power KW	0.164	0.427	0.70	1.06	1.68	2.55
		Output Torque Nm	25.4	76.1	129	197	321	498
50/1	30	Input Power KW	0.112	0.309	0.53	0.820	1.31	1.91
		Output Torque Nm	20.9	65.0	115	180	301	446
60/1	25	Input Power KW	0.096	0.240	0.38	0.60	1.00	1.55
		Output Torque Nm	14.8	43.5	75.2	121	264	412
70/1	21.4	Input Power KW	0.090	0.206	0.35	0.53	1.81	1.18
		Output Torque Nm	14.6	43.7	74.0	118	198	305

Nominal Ratio RPM	Nominal Output	Capacity	Unit Size				
			400	500	600	700	800
5/1	300	Input Power KW	12.8	20.9	38.4	51.5	70.4
		Output Torque Nm	372	629	1130	1560	2140
7.5/1	200	Input Power KW	9.18	17.5	26.3	41.5	54.4
		Output Torque Nm	405	769	1190	1860	2450
10/1	150	Input Power KW	8.36	15.9	23.1	31.9	41.3
		Output Torque Nm	467	914	1330	1840	2390
12.5/1	120	Input Power KW	7.25	-	-	-	-
		Output Torque Nm	530	-	-	-	-
15/1	100	Input Power KW	6.67	11.3	20.0	27.6	37.1
		Output Torque Nm	541	927	1700	2360	3190
20/1	75	Input Power KW	5.81	10.4	15.9	21.5	29.4
		Output Torque Nm	618	1130	1800	2370	3280
25/1	60	Input Power KW	4.76	8.00	12.5	19.7	26.9
		Output Torque Nm	616	1060	1680	2680	3710
30/1	50	Input Power KW	4.25	7.45	11.8	16.2	21.6
		Output Torque Nm	641	1160	1880	2610	3500
35/1	42.9	Input Power KW	-	6.71	10.3	14.2	-
		Output Torque Nm	-	1190	1880	2580	-
40/1	37.5	Input Power KW	3.50	5.72	9.64	13.7	17.9
		Output Torque Nm	673	1110	1960	2830	3740
50/1	30	Input Power KW	2.68	4.74	7.81	11.9	15.7
		Output Torque Nm	603	1110	1900	2980	3950
60/1	25	Input Power KW	2.29	4.16	6.24	9.4	13.2
		Output Torque Nm	593	1140	1750	2720	3870
70/1	21.4	Input Power KW	1.98	3.40	5.35	7.75	10.9
		Output Torque Nm	577	1030	1670	2490	3540

SC Industrial Syndicate



Ratings at 1500 RPM Input Speed

Nominal Ratio	Nominal Output RPM	U & V TYPE UNIT SIZE				O TYPE UNIT SIZE		
		1000	1200	1400	1700	1000	1200	1400
Input Power	- Mechanical	KW	KW	KW	KW	KW	KW	KW
Output Torque	- Mechanical	Nm	Nm	Nm	Nm	Nm	Nm	Nm
Input Power	- Thermal	KW	KW	KW	KW	KW	KW	KW
Output Torque	- Thermal	Nm	Nm	Nm	Nm	Nm	Nm	Nm
5/1	300	121 3690 88.2 2680	180 5470 124 3790	249 7460 Forced Lubrication	- - - -	121 3690 88.2 2680	180 5470 122 3720	249 7460 Forced Lubrication
7.5/1	200	89 4030 74.8 3380	138 6220 108 4900	186 8420 155 7030	- - - -	89 4030 74.8 3380	138 6220 106 4790	186 8420 131 5990
10/1	150	62.3 3630 67.3 3920	113 6630 97.8 5750	152 8940 146 8590	318 19200 193 11600	62.3 3630 67.3 3920	113 6630 94.6 5600	152 8940 123 7290
12.5/1	120	- - - -	90.6 6760 90.7 6770	141 10700 125 9490	- - - -	- - - -	90.6 6760 87.3 6570	141 10700 98 7490
15/1	100	55.5 4800 54.1 4680	79.4 6900 81.1 7040	146 12800 115 10100	242 21200 164 14300	55.5 4800 52.3 4550	79.6 6900 72.5 6350	146 12800 87.6 7710
20/1	75	52.8 6050 45.5 5190	82.5 9490 67 7690	118 13600 100 11500	206 23700 131 15000	52.8 6050 40.8 4700	82.5 9490 55.1 6390	118 13600 72.3 8400
25/1	60	43.5 6070 36.4 5060	65.9 9290 54.4 7760	93.1 13100 79.5 11200	152 21600 104 14600	43.5 6070 30.9 4340	65 9290 42.7 6170	93.4 13100 56.4 8010
30/1	50	36.9 6080 31.6 5180	59.3 9890 49 8140	84.4 14600 69.3 11900	148 24700 96.6 16000	36.9 6080 26.1 4330	59.3 9890 36.8 6200	84.4 14600 47.2 8230
35/1	42.9	- - - -	47.1 9250 42.8 8390	- - - -	- - - -	- - - -	47.1 9250 30.6 6100	- - - -
40/1	37.5	31.8 6830 24.6 5250	49.9 10900 3702 8060	70 15200 50 10700	100 22000 74.4 16200	31.8 6830 18.5 4010	49.9 10900 25.7 5660	70 15200 31.7 6990
50/1	30	26.6 6880 20.9 5350	40.4 10600 31 8100	57.9 15000 41 10700	109 29100 64.5 16800	26.6 6880 14.5 3770	40.4 10600 19.6 5220	57 15000 24.1 6420
60/1	25	22.5 6750 18.1 5390	34.4 10400 26 7740	52.6 16300 38.4 11900	69.6 27900 49.3 17200	22.5 6450 11.5 3480	34.4 10400 15 4560	52.6 16300 20.7 6470
70/1	21.4	18.5 6340 17.2 5850	29.7 10400 25.4 8790	43.8 15200 32.4 11100	74.2 26200 47.3 16200	18.5 6340 9.92 3440	29.7 10400 13.2 4700	43.8 15200 15.5 5450

SC Industrial Syndicate

Sizes 1000 to 1700

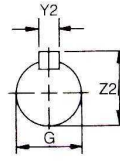
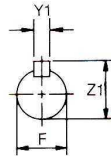
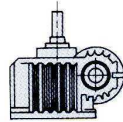
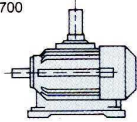

Input Shaft

Output Shaft

Sizes 400 to 800

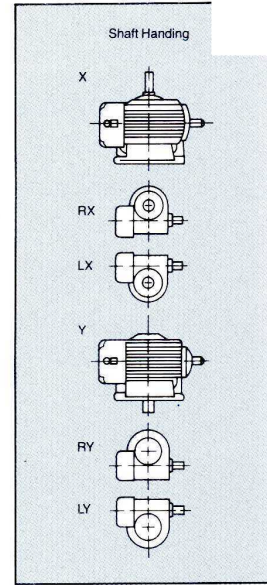
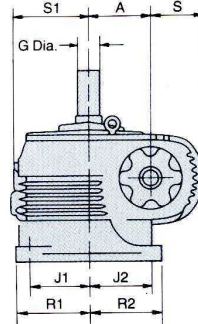
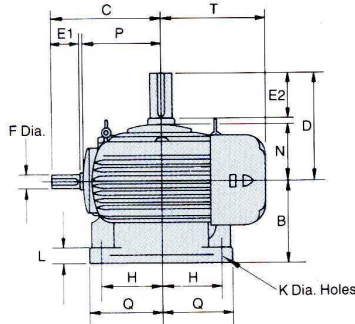
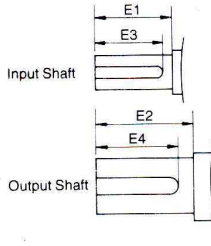

Single reduction speed reducers



Principal Dimensions (mm)

SIZE	A	B	C	D	E1	E2	E3	E4	F	G	H	J1	J2	K	L	N	P	Q	R1	R2	S	S1	T	Y1	Y2	Z1	Z2
400	101.6	171.5	229	216	67	89	54	83	31.750 31.735	44.450 44.435	114.3	114.3	114.3	20.6	32	121	159	140	140	140	111	152	222	7.976 7.925	11.176 11.125	34.47 34.24	47.73 47.50
500	127.0	190.5	260	248	73	102	73	95	38.100 38.085	50.800 50.782	139.7	139.7	139.7	20.6	32	133	184	165	165	165	124	178	254	9.576 9.525	12.751 12.700	40.72 40.49	53.98 53.75
600	152.4	209.6	279	273	76	114	73	114	38.100 38.085	57.150 57.135	152.4	152.4	152.4	23.8	38	140	200	184	184	184	133	197	270	9.576 9.525	15.926 15.875	40.49 40.49	61.75 61.52
700	177.8	228.6	318	298	86	127	83	114	44.450 44.435	63.500 63.482	177.8	177.8	177.8	23.8	38	151	229	210	210	210	143	222	305	11.176 11.125	15.926 15.875	47.73 47.50	68.10 67.87
800	203.2	241.3	343	311	89	140	83	127	44.450 44.435	69.850 69.832	203.2	203.2	203.2	27.0	44	159	251	238	238	238	149	254	327	11.176 11.125	19.101 19.050	47.73 47.50	75.03 74.80
1000	254.0	279.4	425	375	121	152	89	143	57.150 57.135	82.550 82.527	260.4	260.4	235.0	31.8	51	194	311	311	299	273	160	298	378	15.926 15.875	22.276 22.225	61.75 61.52	89.13 88.87
1200	304.8	304.8	495	413	124	171	89	162	63.500 63.482	95.250 95.227	317.5	317.5	266.7	34.9	57	216	368	368	356	305	177	356	441	15.926 15.875	25.476 25.400	68.10 67.87	103.20 102.95
1400	355.6	330.2	572	483	149	191	146	210	76.200 76.182	114.300 114.277	355.6	355.6	304.8	41.3	64	254	425	425	413	362	203	413	521	19.101 19.050	31.826 31.750	81.38 81.15	123.47 123.22
1700	431.8	406.4	699	546	181	203	152	222	82.550 82.527	139.700 139.675	431.8	431.8	431.8	41.3	76	305	514	502	502	502	241	502	629	22.276 22.225	38.202 38.100	89.13 88.90	150.04 149.73

Standard Nominal Ratios

400	5	7.5	10	12.5	15	20	25	30	—	40	50	60	70
500	5	7.5	10	—	15	20	25	30	35	40	50	60	70
600	5	7.5	10	—	15	20	25	30	35	40	50	60	70
700	5	7.5	10	—	15	20	25	30	35	40	50	60	70
800	5	7.5	10	—	15	20	25	30	—	40	50	60	70
1000	5	7.5	10	—	15	20	25	30	—	40	50	60	70
1200	5	7.5	10	12.5	15	20	25	30	35	40	50	60	70
1400	5	7.5	10	12.5	15	20	25	30	—	40	50	60	70
1700	—	—	10	—	15	20	25	30	—	40	50	60	70

Approximate Shipping Specification and Oil Capacities

Size	400	500	600	700	800	1000	1200	1400	1700
Net weight (kg)	77	109	145	200	254	465	690	970	1750
Gross weight (kg)	90	125	163	226	286	580	830	1250	2100
Volume - Wheelshaft up	.12	.17	.21	.28	.44	1.0	1.4	1.9	2.8
packed (cu.m.) - Wheelshaft down	.11	.15	.19	.25	.39	.9	1.3	1.75	2.6
Oil required at 1st filling (lit)	4.0	5.7	6.3	10.2	12.5	22.7	37.4	68.5	105

As improvements in design are continually being made, this specification is not regarded as binding in detail, and dimensions are subject to alteration without notice.